



# Watson Elementary

## New Student Information



### School Hours/Office Hours

School Hours: 8:00 a.m. to 2:40 p.m.

Office Hours: 7:30 a.m. to 3:30 p.m.

Students may arrive at 7:45 a.m.

Breakfast is served daily in our cafeteria beginning at 7:55.

### Arrival and Dismissal

Please see the attached map for the traffic pattern for student drop-off and pick-up. Read below to find out where your child will go during arrival and dismissal.

#### **Bus Riders**

- Buses will park in the main drive in front of Watson and Grimmer during arrival and dismissal times. This main drive will be restricted to buses only from 7:30 a.m.-9:00 a.m. and 2:15 p.m.-4:00 p.m.
- Students attending breakfast will be let off of the buses at 7:50 to go to the cafeteria.
- All students riding a bus will enter and exit the building at door AA.

#### **Walkers**

- Students who walk to school will enter the building at door BB in the morning.
- In the afternoon, students walking home will exit the building at door AA.

#### **Adventure Club**

- Students who are attending Adventure Club will be called to the cafeteria over the intercom at dismissal.

### Arrival and Dismissal continued

Please see the attached map for the traffic pattern for student drop-off and pick-up. Read below to find out where your child will go during arrival and dismissal.

#### **Car Riders**

- **During arrival**, car riders will enter from the far west drive (behind Grimmer) and exit at the far east drive.
- Early childhood parents should park in the lot and walk your child to door AA to meet staff.
- If you are a K-4 family and you drive your child to school, you should not park in the lot to walk with your child. Please go through the car rider line.
- Cars should pull up to the stop sign by the playground and stop to let your child out the left side of the vehicle. Students will walk to door BB and enter the building.
- If you arrive late, you must park and accompany your child into the office.
- **During dismissal**, car riders will enter from the far west drive (behind Grimmer) and exit at the far east drive.
- Once the gate is unlocked/opened, vehicles will pull all the way around the building to the stop sign by the playground.
- In the afternoon only, please place a sign in your window with the child's name, grade, and teacher's name. Signs are available at Watson. One side of the sign is green and the other side has the above information listed. Once your child is safely in your vehicle, flip your sign to the green to signal our staff that you are ready to move. This will help with dismissal.

### Registration

Online registration is an annual event for all Watson students in August. If you have not created your account and completed your registration, it is important for you to complete this as soon as possible.

### Office Information

All visitors who enter the building must stop at the desk in the main entrance, sign in, and receive a visitor's badge. You must provide a driver's license.

If you are planning to volunteer this year, you must complete a background check. Forms are available in the office and require a copy of your driver's license. Background checks must be completed each year.

Our bookstore will be open for students on Tuesdays and Thursdays for students who wish to buy supplies.

Please check our website for our most recent newsletter and the supply list.  
[www.watson.lcsc.us](http://www.watson.lcsc.us)

Sign up for the Eventlink calendar on the LCSC web page for more information about scheduled events. You will find the Eventlink link under "Quick Links" in the middle of LCSC web page.

Book fees can be paid on-line and must be paid in full by January 31.



### Transportation

All Watson students are eligible for bus service. To find your bus route, go to [www.lcsc.us](http://www.lcsc.us). Under the departments tab click the transportation link. Click the find bus route button. Your information will be listed there.

Due to traffic congestion, we encourage all students to take advantage of the bus service.

Please make sure your child knows how they should go home each day. We encourage you to send in a weekly note if your child is going home a different way each day.

Any changes to your child's end of day transportation must be called into the office by 1:30. Do not email the teacher for transportation changes.

### Breakfast & Lunch

Breakfast and lunch menus are available on our district website. [www.lcsc.us](http://www.lcsc.us) It is under the departments tab. You will click food services.

You can deposit money into your child's lunch account through skyward.

Lunch: \$2.30/reduced lunch \$0.40

Breakfast: \$1.60/ reduced breakfast \$0.30



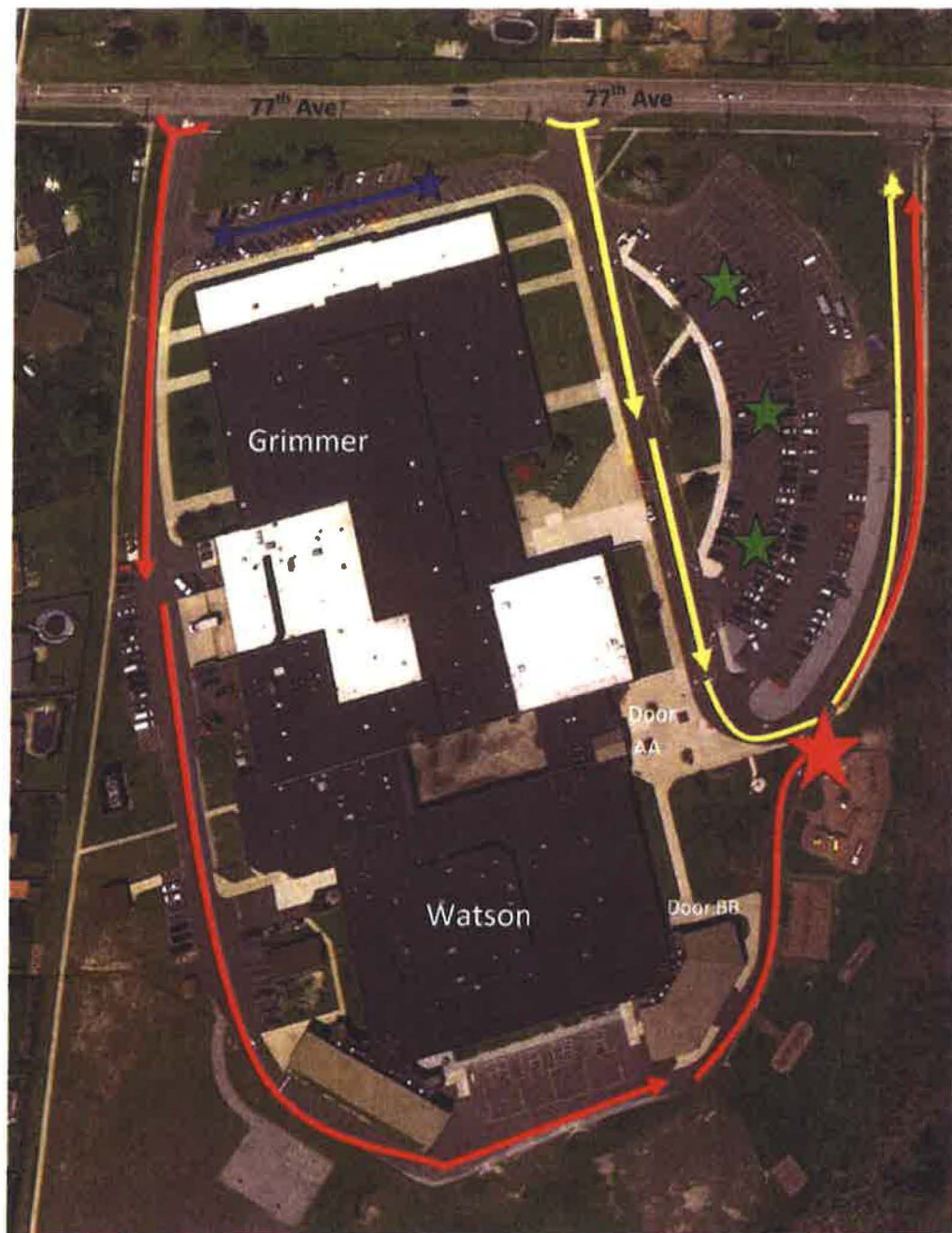

Red arrows -  New parent drop off traffic flow

Red star -  - New drop off/ pick up area for Watson and Grimmer students

Yellow arrows -  Bus drop off/pick up flow;  
restricted to buses only 7:30a.m. -9a.m. & 2:15p.m.-4:00p.m.

Blue stars -  - Entrance and parking lot for Grimmer staff only

Green stars -  - Parking lot for visitors to school office  
(parents picking up child during day, etc.)