

Watson Elementary Newsletter

August/September 2018

Welcome Back!!



Welcome back for the 2018-2019 school year! It is hard to believe that summer is almost over and we are ready to come back to school. Our office is open daily from 7:30-3:30. Watson would like to welcome the following new staff members:

Mrs. Gina Mielcarek, Dean of Students
Ms. Sandy Will-Brumm, Early Childhood

and Welcome Back to:

Mrs. Karen Radencic, 1st grade

We are looking forward to a terrific year!
Please read the important information below:

- Arriving at school on time is important!
If you are dropping off your child in the car ride line, please arrive early!
We have supervision beginning at 7:45 daily.
- Please make sure your child knows how to go home each day (car rider, bus rider, Adventure Club, or walker).
 - Any changes in the end of day transportation for your child should be called into the office before 1:30.
Please do not rely on email for transportation changes. Teachers do not always have a chance to check email during the school day.

Office News

If you are planning on volunteering this year, you must complete a background check. Forms are available in the office. Background checks must be completed each year.

Our bookstore will be open for students on Tuesdays and Thursdays for students who wish to buy supplies. Student agendas will be passed out to all students in grades 1-4. They will not be sold at the bookstore.

All Watson students are now eligible for bus service. To find your bus route, go to www.lcsc.us. Under the departments tab click the transportation link.

Open House/Pasta Dinner

Our annual Open House/Pasta dinner will be held on Wednesday, August 29 from 5-7:30. Forms will go home with students on Tuesday, August 14. If you are interested in ordering the pasta dinner, you must return the form along with payment by Friday, August 18. All Watson families are welcome to attend! Our kindergarten and early childhood families are welcome to attend the Pasta Dinner although the open house for those levels are held on a different day.

Summer Reading

If you completed the summer reading challenge, please turn in your form on or before August 20. All students who completed the summer reading challenge will be invited to a special recognition breakfast and will also receive a magnet that says "Summer Reading Champion."

Arrival and Dismissal

Please see the attached map for the traffic pattern for student drop-off and pick-up. Read below to find out where your child will go during arrival and dismissal.

Car Riders

- **During arrival**, car riders will enter from the far west drive (behind Grimmer) and exit at the far east drive.
- Early childhood parents should park in the lot and walk your child to door AA to meet staff.
- If you are a K-4 family and you drive your child to school, you should not park in the lot to walk up your child. Please go through the car rider line.
- Cars should pull up to the stop sign by the playground and stop to let your child out the left side of the vehicle. Students will walk to door BB and enter the building.
- If you arrive late, you must park and accompany your child into the office.
- **During dismissal**, car riders will enter from the far west drive (behind Grimmer) and exit at the far east drive.
- Once the gate is unlocked/opened, vehicles will pull all the way around the building to the stop sign by the playground.
- In the afternoon only, please place a sign in your window for staff to see with the child's name, grade, and teacher's name. Signs will be available at Watson. One side of the sign is green and the other side has the above information listed. Once your child is safely in your vehicle, flip your sign to the green to signal our staff that you are ready to move. This will help with dismissal.

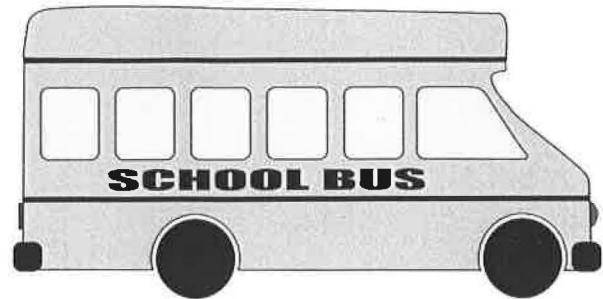

Arrival and Dismissal Continued

Bus Riders

- Buses will park in the main drive in front of Watson and Grimmer during arrival and dismissal times. This main drive will be restricted to buses only from 7:30 a.m.-9:00 a.m. and 2:15 p.m.-4:00 p.m.
- Students attending breakfast will be let off of the buses at 7:50 to go to the cafeteria.
- All students riding a bus will enter and exit the building at door AA.

Walkers

- Students who walk to school will enter the building at door BB in the morning.
- In the afternoon, students walking home will exit the building at door AA.

Adventure Club

- Students who are attending Adventure Club will call the cafeteria over the intercom at dismissal.

Important Dates

August

- 8- Open House for Kindergarten and Early Childhood classes at 5:30
- 9- Building open from 10-6 (pay book fees)
- 13-Kindergarten bus ride 10:00
- 14-First day of school
- 17-Pasta dinner forms due
- 29-Open House/Pasta Dinner

September

- 3 -No school/Labor Day
- 4 -Kindergarten trip/apple orchard
- 5 -PTO meeting 6:30 p.m. cafeteria
- 24-28- PTO Spirit Week
- 28-Wildcat Walk

October

- 15-19-Book fair week
- 15-Last day of 1st quarter
- 16-1st day of 2nd quarter
- 18-Family Night/Book & Art Fair
- 19-Kindergarten trip/pumpkin patch
- 22-24-PTO pumpkin decorating contest
- 25-26-No School
- 31-Holiday party day

November

- 6- PTO meeting 3:00
- 22-23- No school/Thanksgiving
- 30-PTO Holiday Carnival

December

- 12-14- PTO Santa Shop
- 20-Holiday party day
- 21-Last day before break/End of Quarter 2
- 24-January 7 winter break

Important Dates Continued

January

- 8 -First day back from winter break
- 15-PTO meeting 3:00
- 21-No school/Martin Luther King Jr. Day

February

- 14-Holiday party day
- 18-No school/Presidents Day
- 28-District wide Kindergarten Parent meeting (for 2019-2020 kindergarten students)

March

- 12- PTO meeting 3:00
- 13-3rd Quarter ends, Kindergarten enrollment
- 14-Kindergarten enrollment
- 18-22- IREAD testing grade 3
- 20-Kindergarten hands-on workshop for 2019-2020 kindergarten parents
- 25-29-No school/spring break

April

- 19-No school/Easter break
- 22-May 17-ILEARN testing window (test for 3rd and 4th replacing ISTEP)

May

- 14-PTO meeting 3:00
- 17-4th grade party
- 24-Last day for students

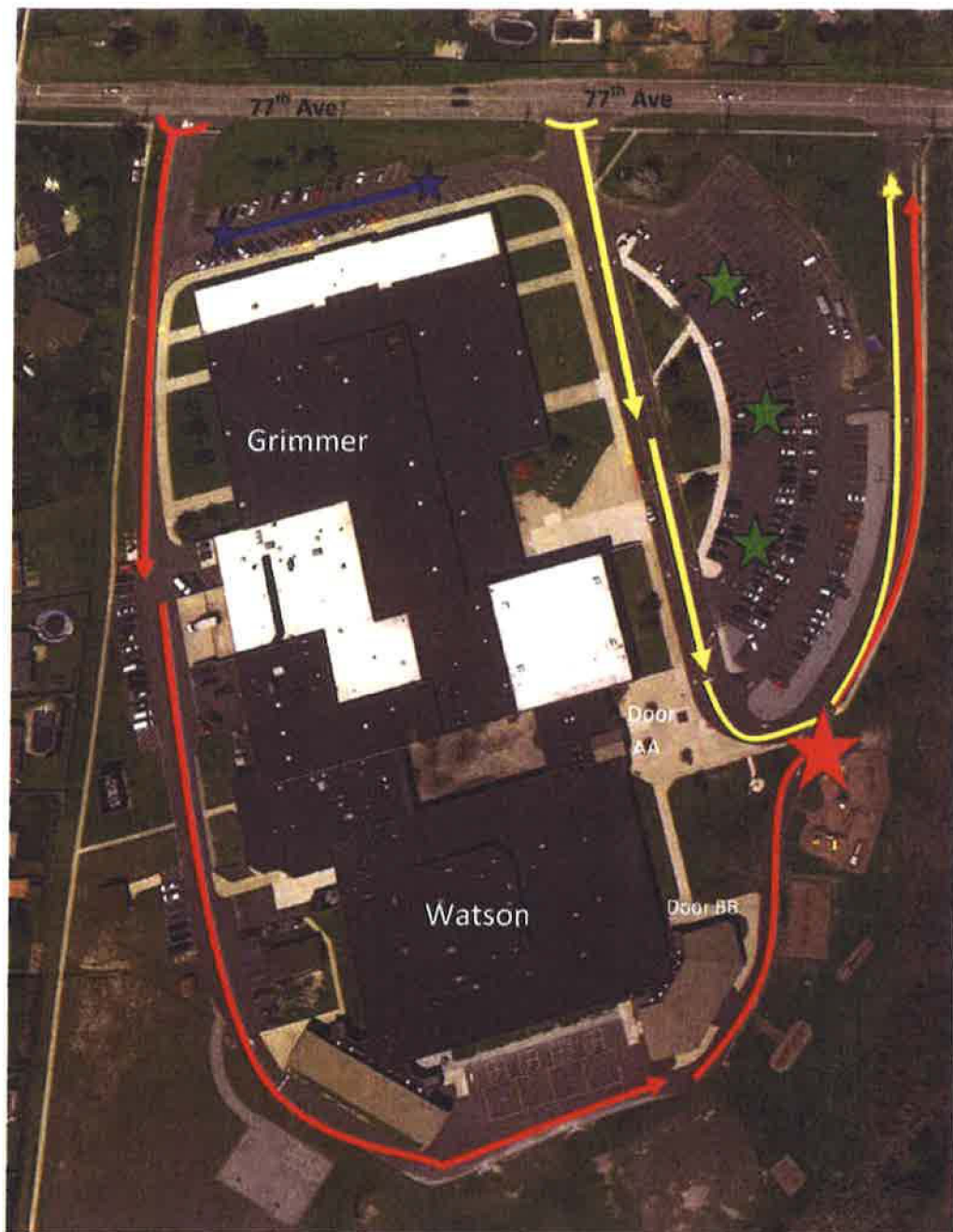

Red arrows -  New parent drop off traffic flow

Red star -  - New drop off/ pick up area for Watson and Grimmer students

Yellow arrows -  Bus drop off/pick up flow;
restricted to buses only 7:30a.m. -9a.m. & 2:15p.m.-4:00p.m.

Blue stars -  - Entrance and parking lot for Grimmer staff only

Green stars -  - Parking lot for visitors to school office
(parents picking up child during day, etc.)