



# **Watson Elementary School**

## **August 2017**



---

Welcome back to the 2017-2018 school year! It is hard to believe that summer is just about over and we are ready to come back to school. Our office is open daily from 7:30 a.m. to 3:30 p.m. Watson would like to welcome the following new staff members:

Mr. Brett Wartman-Dean of Students (Thursday and Friday)

Mrs. Jennifer Zollman-3rd grade teacher

Mrs. Stephanie Trzupek-2nd grade teacher

Miss Katherine Gikas-Early Childhood teacher

We are looking forward to a terrific school year!

Here are some important points:

- Arriving at school on time is important. If you drop your child off in the car rider line, please arrive early! We have supervision beginning at 7:45 daily.
  - Please make sure that your child knows how to go home each day (car rider, bus rider, adventure club, or walker). We recommend sending a note to the teacher.
  - Any changes in the end of day transportation for your child should be called into the office before 1:30. Please do not rely on email for transportation changes. Teachers do not always have a chance to check email during the school day.
  - Please watch for our monthly newsletter to keep you informed about Watson. It will be posted monthly on our website.
-

---

## Office News

When entering Watson, please stop in the office, sign in, and get a visitor's badge. We ask all of our visitors to follow this rule to keep our building safe. Thank you!

If you are planning on volunteering this year, you must complete a background check. Forms are available in the office. Background checks must be completed yearly.

Our bookstore will be open on Tuesdays and Thursdays for our students to buy supplies. Students in second through fourth grade **will not** need to purchase an agenda this year from the bookstore. They will receive the agenda in class. Students in first grade **will not** need a special writing folder from the bookstore. They will receive the special writing folder in class.

---

## Open House/Pasta Dinner

Our annual Open House/Pasta Dinner will be held on Wednesday, August 23 from 5-7:30. Forms will go home with students on Monday, August 14. If you are interested in ordering the pasta dinner, you must return the form along with payment by Friday, August 18. All Watson families are welcome to attend! Our kindergarten and early childhood classes met with their teachers on Wednesday, August 9. The Open House schedule will be as follows:

5:30-5:55 Third Grade

6:00-6:25 Fourth Grade

6:30-6:55 First Grade

7:00-7:25 Third Grade

---

---

## **PTO News**

The first PTO meeting of the year will be held on Tuesday August 29 at 6:30 p.m. in the cafeteria. We encourage you to attend and become an active member of our PTO. Membership dues are \$8. The membership drive runs through August 22. We hope you will consider attending our meeting.

The Watson PTO is selling spirit wear. Order forms are available online. The sale ends August 26. There will also be special discounted shirts available for purchase at our Open House on August 23.

<https://watson2017.itemorder.com/sale>

---

## **Summer Reading Forms**

We are hoping that many of our students participated in our summer reading program! If you completed the reading challenge, please turn in your form on or before August 18. All students who completed the summer reading challenge will earn breakfast with the principal and librarian. Students will also receive a magnet to display.

---

## **Arrival and Dismissal**

Please see the attached map for the traffic pattern for student drop-off and pick-up. Read below to find out where your child will go during arrival and dismissal.



## **Car Riders**

During arrival, car riders will enter from the far west drive (behind Grimmer) and exit at the far east drive. Only those parents who need to enter the building or pre-school parents should park in the lot. All students will be picked up and dropped off in the zone designated by the red star. Your child should exit from the driver's passenger side and be ready to exit the vehicle when you enter the drop-off zone. If you arrive late, you must park and accompany your child into the office.

At dismissal, you will drive around the far west drive (behind Grimmer) and you will be directed by Watson staff to a line where you will park and wait for your child to load your vehicle. Please put a sign in your driver's side window with your child's full name, grade, and teacher's name to help with dismissal. We have signs available at Watson (one side has the above information & the other side is green). Once your child is safely in your vehicle, flip your sign to green to signal our staff that you are ready to move. Our staff will direct all cars when to move.

## **Bus Riders**

Buses will park in the main drive in front of both schools during arrival and dismissal times. This main drive will be restricted to buses only from 7:30 a.m.-9:00 a.m. and 2:15 p.m.-4:00 p.m.

## **Walkers**

Walkers will enter the building at door BB with the car riders and exit through door AA.

## **Adventure Club**

Students who are attending Adventure Club will be called to the cafeteria at dismissal.



---

## Important Dates

### August

9-Kindergarten and Early Childhood Meet the Teacher Night

10-Building open from 10-6

11-Schedules available online, Kindergarten trial bus ride

14-First day of school

23-Open House (grades 1-4) & Pasta Dinner

### September

4-No school

7-PTO sponsored Family Movie Night

18-22-Watson Spirit Week

22-Wildcat Walk

---



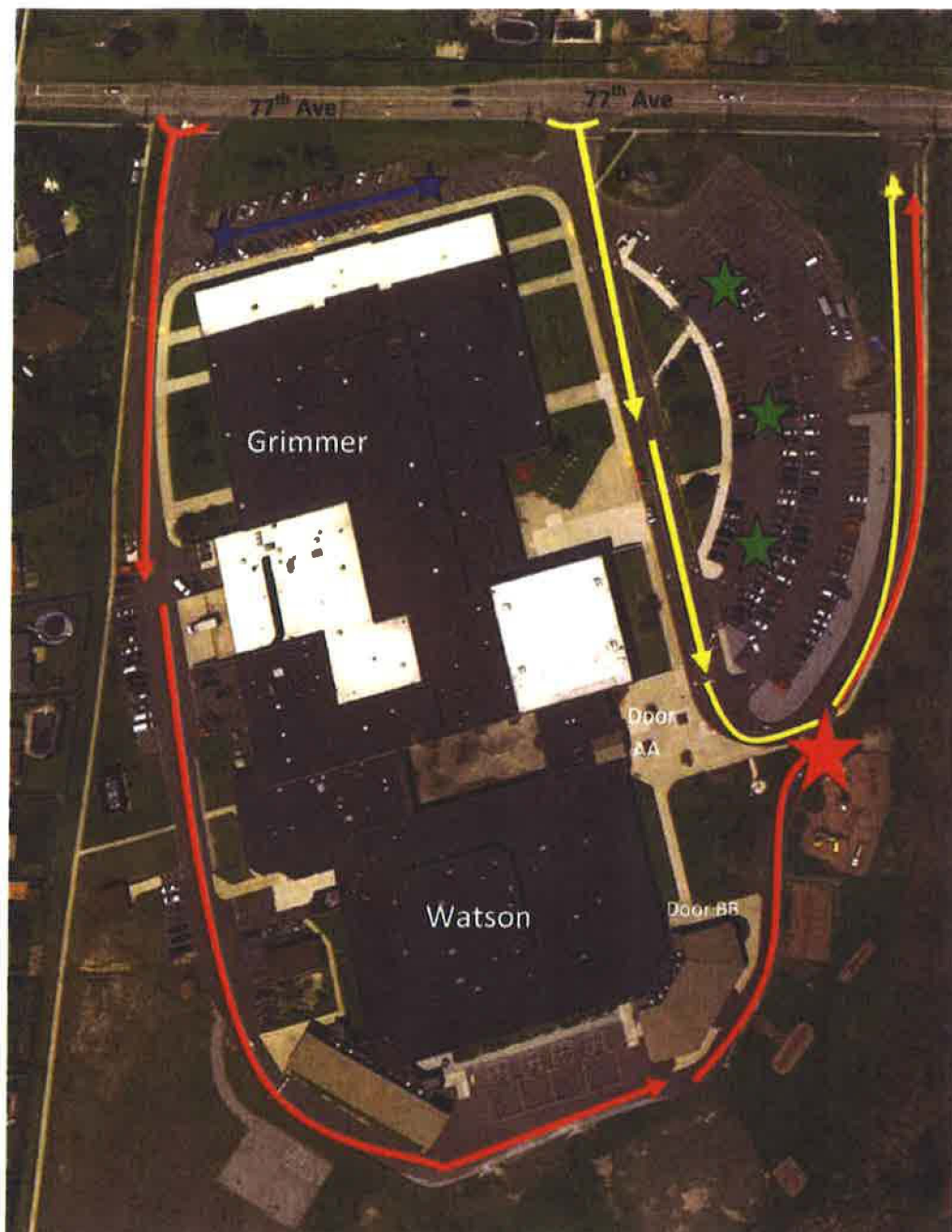

Red arrows -  New parent drop off traffic flow

Red star -  - New drop off/ pick up area for Watson and Grimmer students

Yellow arrows -  Bus drop off/pick up flow;  
restricted to buses only 7:30a.m. -9a.m. & 2:15p.m.-4:00p.m.

Blue stars -  - Entrance and parking lot for Grimmer staff only

Green stars -  - Parking lot for visitors to school office  
(parents picking up child during day, etc.)