

Kahler Athletic's Tryout Information '21

★ Directions for Trying Out for a sport: Athlete's Need a White Card

1. Must have a **Correct 5 page IHSA Physical** given to or on file with the Athletic Director
 - a. The correct 5 pg IHSA Physical must be handed **directly** to the AD **by the athlete**
 - b. The correct 5 pg IHSA Physical must be dated after **April 1st of the previous year**
Only 1 Physical is needed per school year
 - c. Unacceptable Physicals = Any # of pages from a doctor's office form
Any # page physical **NOT** on the correct IHSA form

***Note: IHSA is allowing physicals from last year to be used for this season (2021) only!**

2. Must be **Registered on Family ID for 2020 - 2021 Kahler Athletics Season & Sport**

See 2nd page for instructions

If you have an account already, information will transfer. Must save again!

White Cards:

White Cards are issued after the completion of steps # 1 & 2 above;
an athlete will then receive a White Card from the AD. This White
Card must be given to the coach for an athlete to try out/participate.

★ Directions for Playing a Sport at Kahler Middle School

- 1) Pay the team sports fee directly to the **Coach** = \$30.00 for each sport
This covers team fees, equipment and other team expenses
Paid directly to the coach with check/cash. Checks made payable to Kahler Athletics
Please put in an envelope with the athlete's name, grade and sport
- 2) Pay a Kahler Athletic Transportation Fee = \$20.00
Paid Directly on **Skyward** after your athlete's name is officially on the sports' roster
Please do NOT give this fee to the coach
- 3) Please pay a LC Corp Athletic Participation Fee = \$60.00
A one time fee for the athlete's first sport, covers the whole school year.
This fee is only paid once no matter how many sports played
Paid directly on **Skyward** after your athlete's officially on the roster

Schedules:

Kahler Athletic's Tryout Information '21

*Please follow your athlete's **schedule** on **Eventlink**: See 2nd page for instructions and any schedules given to the athlete by the coach

Parent Family ID steps:

1. Find the link and select "Find a Program"; Type "Kahler Middle School" -click "find"
2. Click on Kahler Middle School, click on the correct program (in blue)
3. Next click on the green **Register Now** button and scroll, if necessary, to the **Create Account/Log In** green buttons. If this is your first time using FamilyID, click **Create Account**. Click **Log In**, if you already have a FamilyID account.
4. **Create** your secure FamilyID account by entering the account owner's first and last names (parent/guardian), email address and password. Select **I Agree** to the FamilyID Terms of Service. Click **Create Account**.
5. You will receive an email with a link to activate your new account. (If you don't see the email, check your Email filters (spam, junk, etc.).
6. Click on the link in your activation Email, which will log you in to FamilyID.com
7. Complete the information requested. All fields with a red* are required.
8. Click the **Save & Continue** button when your form is complete.
9. Review your registration summary.
- 10 A physical must be printed from the site and completed correctly

Parent Eventlink steps:

- Go to eventlink.com
- Add schools - Kahler Middle School
- Add notifications & contact points
- Add calendars
 - click my calendars
 - click manage my calendars

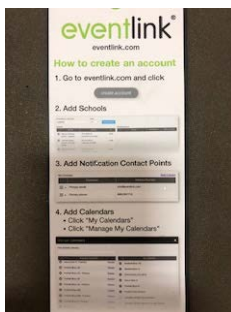

Skyward Fees:

They pay it under their Fee Management Tab
in their Skyward Family Access
This is what parents see...

[illegible]

Inquiries?

Please contact Mr. Gray - Athletic Director at bgray@lcscmail.com, 219-865-3535 x4307